



# Beautiful, affordable custom kitchens DELIVERED ON TIME, EVERY TIME.

## SOFT CLOSE DRAWERS & DOORS: PEACE IN THE KITCHEN.

Imagine this in your home: cabinet drawers that extend fully and close quietly, and cabinet doors that close quietly. Fieldstone Cabinetry drawers are standard with full extension for easy access, no glide hardware showing, and a whisper quiet close that steers even fully loaded drawers to a smooth, silent closure. Soft close doors are standard on all overlay cabinetry, and on inset cabinetry built with concealed hinges.

## ALL-WOOD CONSTRUCTION, INSIDE AND OUT

- We use all-wood construction to make Fieldstone Cabinetry. There is no cheap wood or fake wood in our cabinetry.
- Our cabinets have substantial end panels—they can handle your granite countertops! Our end panels are made from hardwood plywood that is 3/4" thick.
- We create drawers with 5/8" thick hardwood and dovetail joinery.
- Because the glides are underneath, drawers can be as wide as possible, giving you more room and more organizational options.
- Shelves are 3/4" thick hardwood plywood. The shelves are adjustable, so you can arrange your cabinets exactly how you want.
- The interiors are bright, light and easy to keep clean.

For more information, ask for the *Cabinetry Comparison Workbook*.

Overlay Construction



Inset Construction

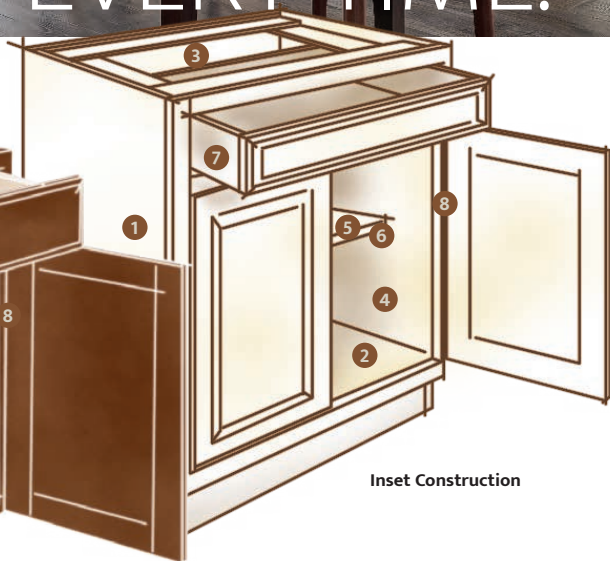

	Overlay Construction	Inset Construction
1. End (side) Panels Several options, including	3/4" hardwood plywood veneer core-unfinished Finished, Flush, Furniture, Beaded, Decorator	3/4" hardwood plywood veneer core-unfinished Finished, Flush, Beaded, Furniture
2. Tops & Bottoms	1/2" hardwood plywood veneer core	1/2" hardwood plywood veneer core
3. Back Panels option option option	1/4" hardwood plywood 3/8" beaded back 3/4" finished back Paneled back	1/2" hardwood plywood 3/8" beaded back 3/4" finished back Paneled back
4. Interiors option option	Natural birch melamine Finished matching veneer Natural maple veneer	Natural birch melamine Finished matching veneer Natural maple veneer
5. Shelves	3/4" hardwood plywood	3/4" hardwood plywood
6. Base Cabinet Shelves option	Two thirds deep Full depth	Two thirds deep Full depth
7. Drawers & Rolls Trays Glides option	5/8" hardwood birch, dovetail joinery Soft close, full extension, undermount, 100 lb. capacity Walnut drawer boxes and roll trays	5/8" hardwood birch, dovetail joinery Soft close, full extension, undermount, 100 lb. capacity Walnut drawer boxes and roll trays
8. Door hinges	Adjustable soft close hinges	Finial hinges in five colors or concealed hinges with soft close mechanism



## INVEST WITH CONFIDENCE

Fieldstone Cabinetry's construction, materials and finishes are covered by a limited Lifetime Warranty.

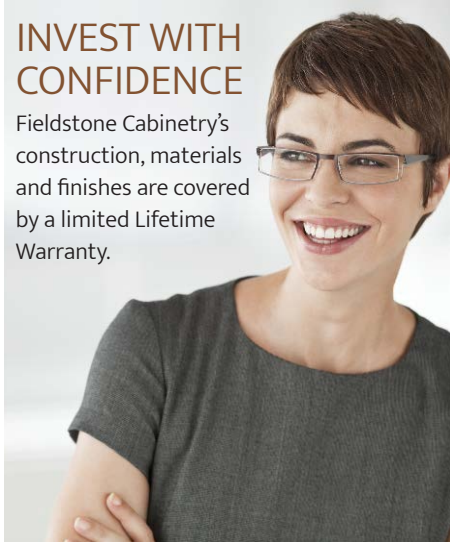

## ENVIRONMENTALLY RESPONSIBLE

Fieldstone Cabinetry is a certified brand in the Kitchen Cabinet Manufacturers Association (KCMA) Environmental Stewardship Program. The program recognizes companies that demonstrate an ongoing commitment to sustainability including the use of environmentally responsible materials in cabinet products and minimized environmental impacts realized through recycling wastes and using low emission coatings. By achieving this certification, Fieldstone Cabinetry is going beyond minimum requirements and demonstrates leadership in growing a sustainable company.



Fieldstone Cabinetry is CARB II compliant and ESP certified.  
Kitchen Cabinet Manufacturers Association Environmental Stewardship Program  
All products impact the environment.  
For ESP program criteria, visit [kcma.org](http://kcma.org).

## A PLACE FOR EVERYTHING

Choose from hundreds of organizational accessories. Ask for the *Organize & Store* brochure.

## OVER 1,000,000 COMBINATIONS PLUS CUSTOM COLORS

You'll find exactly what you want from our wide selection of door styles and colors. Wood types include Alder, Cherry, Hickory, Lyptus, Maple, Oak, Quarter Sawn Oak, Rustic Alder, Rustic Hickory and Walnut. We also offer custom colors and custom distressing. For more information, ask for the *Colors, Styles & Accents* brochure.

## STRONG AT THE FINISH

Each finish we offer creates a unique furniture look, adding beauty, color, and depth to nature's most versatile material: wood.

Additional information about Fieldstone Cabinetry's finish process is found in the *Strong at the Finish* flier. It is posted on the Fieldstone Cabinetry website: [www.fieldstonecabinetry.com/handcrafted-quality](http://www.fieldstonecabinetry.com/handcrafted-quality)

# FIELDSTONE<sup>®</sup>

## CABINETY

600 East 48th Street North • Sioux Falls, SD 57104  
[fieldstonecabinetry.com](http://fieldstonecabinetry.com)

[facebook.com/fieldstonecabinetry](https://facebook.com/fieldstonecabinetry)  
 [instagram.com/fieldstonecabinetry/](https://instagram.com/fieldstonecabinetry/)  
 [pinterest.com/lovefieldstone/](https://pinterest.com/lovefieldstone/)  
 [houzz.com/pro/fieldstonecabinet/fieldstone-cabinetry](https://houzz.com/pro/fieldstonecabinet/fieldstone-cabinetry)  
 [youtube.com/user/CabinetryFieldstone](https://youtube.com/user/CabinetryFieldstone)  
 Send questions to [inquirefs@fieldstonecabinetry.com](mailto:inquirefs@fieldstonecabinetry.com)



### American Craftsmanship

Manufactured in Sioux Falls, South Dakota from domestic and global components

