



MC  
mid continent®  
CABINETS

IDEA BOOK

S SIGNATURE  
MID CONTINENT® CABINETS

July 2017





While we believe we are not defined by the spaces that surround us, **WE ASPIRE TO CREATE ENVIRONMENTS WHERE WE CAN FLOURISH.** Our commitment is to create beautiful built-in furniture for your home that is timeless in design, unique to your tastes and built to last a lifetime at a value that will surprise you. Use this book for inspiration as you plan a space that eases your workload with smart design and storage for all that life throws at you.

welcome home

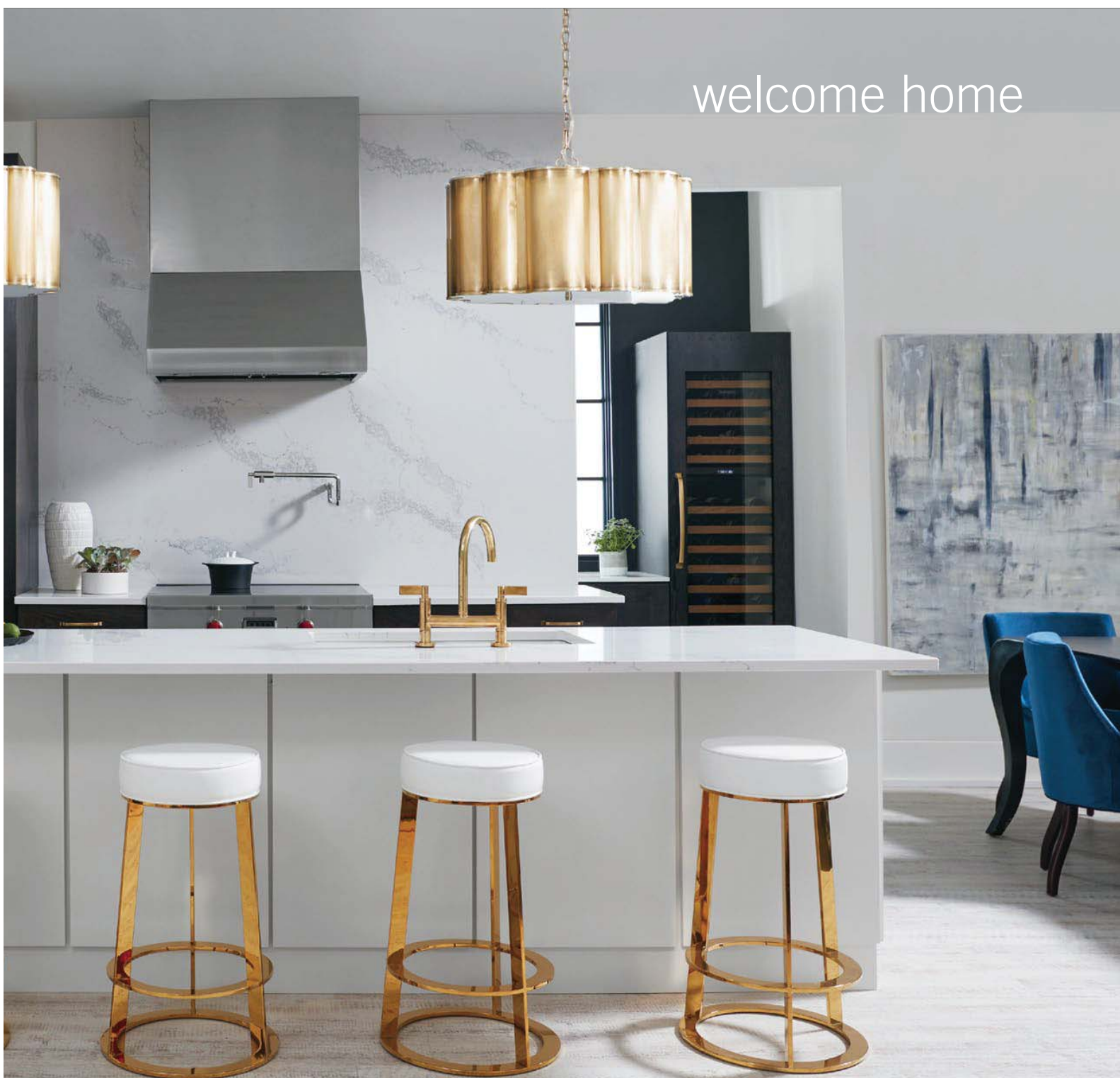





MACKENZIE \* CHERRY BRIARWOOD WITH BLACK GLAZE



MURANO \* PAINTED MAPLE WHITE







COPENHAGEN \* PAINTED MAPLE FLINT



ROHE \* MAPLE ESPRESSO



PACIFICA \* CHERRY SLATE

# kitchens

The kitchen is the hub of the home. BEYOND CREATING A BEAUTIFUL BACKDROP FOR LIFE'S MOMENTS you need an environment that is designed to ease the workload. Whether you choose ornate, traditional, or contemporary door styles your kitchen can be designed around functionality for a smarter space, from prep through cooking, clean up, and storage.









gather in the kitchen





NEWPORT \* CHERRY HUSK WITH BLACK GLAZE





FOCAL POINT. Islands as tables, with quartz and concrete tops using cabinetry as furniture is still very much on trend. Add some open shelving to display special pieces and let your personal style shine.



GARRISON \* PAINTED MAPLE STONE



DUNCAN \* CHERRY CARBON















MISSION \* MAPLE SUNDANCE WITH BLACK GLAZE

LONG LASTING. Durable, functional, beautiful cabinets are finished with attention to detail... to help you complete an authentic, original dream space.































STYLING TOWARDS MODERNISM. Everyone gathers in the kitchen, so make it comfortable and uncluttered. Clean, simple lines and an open floor plan give the illusion of a larger space and the room becomes efficient and easier to maintain.





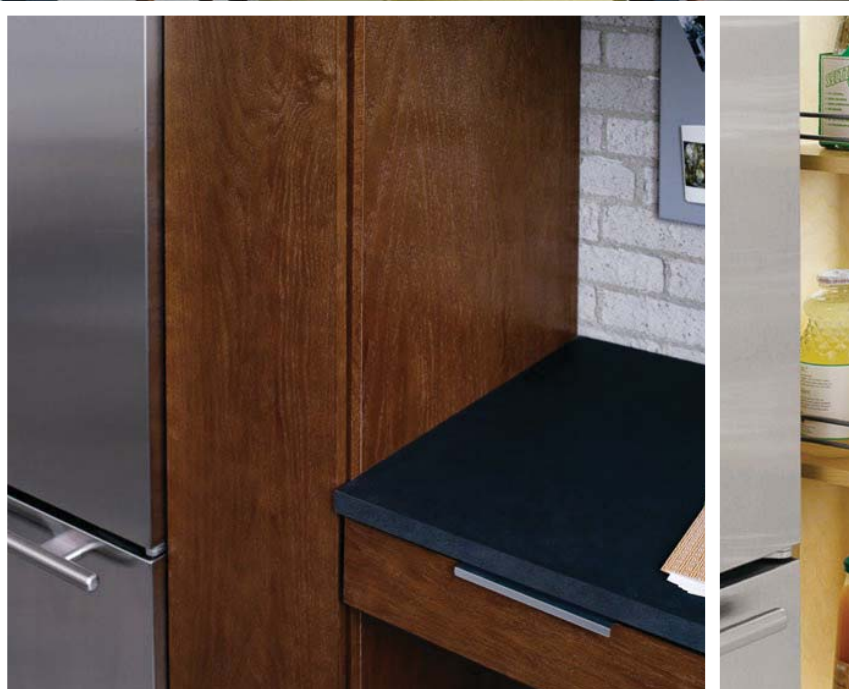



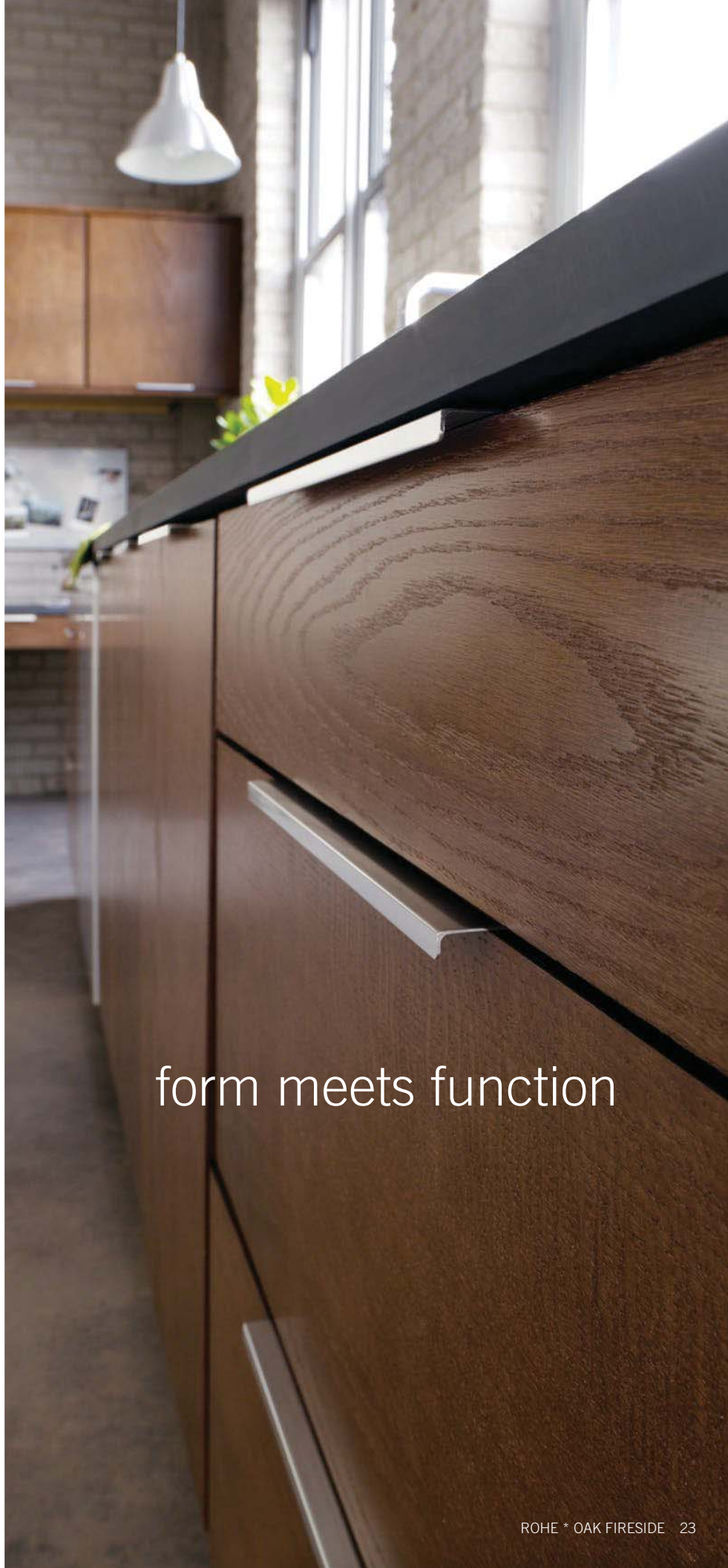

form meets function



Gray is now beating out white as a preferred color. It's more subtle and warm, and looks good with many types of countertops. It has the added BENEFIT OF COMPLEMENTING OTHER SHADES, if the trend of mixing cabinet colors is desired.











DUNCAN \* RUSTIC ALDER HARVEST WITH CHOCOLATE GLAZE



SULLIVAN \* PAINTED MAPLE ANTIQUE WHITE WITH CHOCOLATE GLAZE



WHAT'S YOUR STYLE? Mix ornate and traditional door styles, or painted finishes with natural or stain finishes... or do it all. With thousands of possible door style, finish and species combinations to explore the only rules are that there are no rules.







MISSION \* PAINTED MAPLE EBONY



HANCOCK \* CHERRY FIRESIDE







EASTLAKE \* CHERRY FIRESIDE WITH BLACK GLAZE



TOWNE \* PAINTED MAPLE STONE WITH BLACK GLAZE



ROHE \* PAINTED MAPLE EBONY

# customization

BEYOND THE KITCHEN there are endless opportunities to create attractive, efficient storage throughout your home. Imagine a laundry room that is as inviting as it is functional. Create a mudroom that welcomes, as well as organizes. Accent your living room with custom cabinetry to create a stunning focal point while eliminating clutter.











Not everyone needs a combination mudroom, dog washing corner and potting space. But how cool is that? We give you the ability to BE CREATIVE. Use our customization program to create one-of-a-kind cabinets using standard door and drawer openings and frame parts.













Turn that bare corner into a gift wrapping station using cabinets as furniture or create a more ORGANIZED AND EFFICIENT laundry space using valances, brackets & corbels to add some personality and architectural interest.









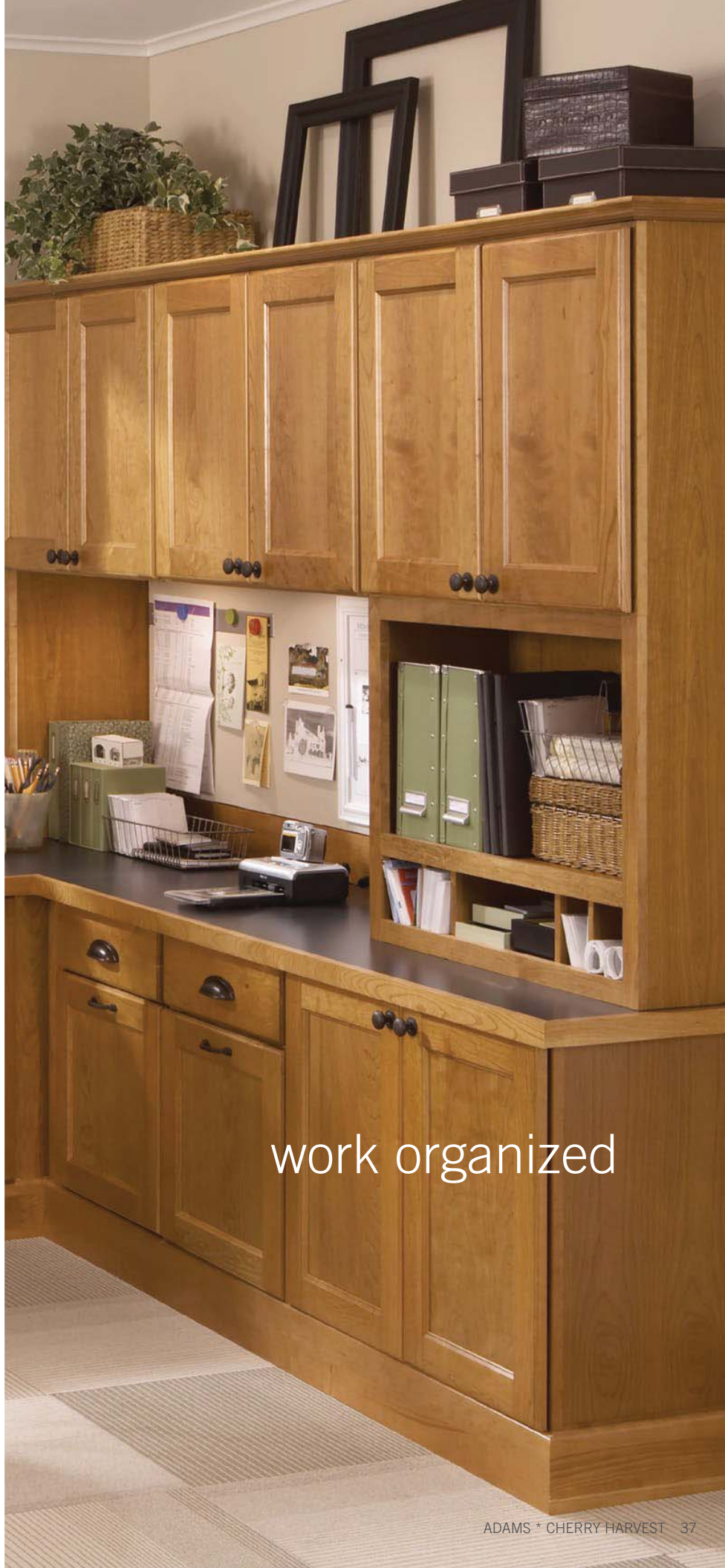

work organized





PARKER \* PAINTED MAPLE WHITE WITH PEWTER GLAZE





BURNHAM \* PAINTED MAPLE WHITE

Our customization program also helps SOLVE SPACE CHALLENGES.

With over 555 cabinet types and sizes you can turn an unused or underused space into something truly functional and beautiful.









ROHE \* CHERRY FIRESIDE



VILLA \* PAINTED MAPLE CUSTOM COLOR WITH CHOCOLATE GLAZE



ADAMS \* CHERRY ESPRESSO

# bath

Relax and rejuvenate...your bath should be AS BEAUTIFUL  
A RETREAT as the rest of your home. Whether your style is  
ornate, traditional or contemporary, we have cabinets and storage  
solutions for your bath. Design the cabinetry to look like furniture to  
complement the rest of your home. The opportunities are infinite.











Furniture style cabinets and vanity in the bath make for a seamless transition from the other rooms in your house. CUSTOMIZE CONSOLE VANITIES with a variety of leg, foot or platform options to fit your personal style.



















THOMAS \* OAK SLATE WITH BLACK GLAZE





Just because you need a lot of storage space in your vanity doesn't mean you have to sacrifice style. Cabinets of varying heights and widths **ADD VISUAL INTEREST**, and design options like clear glass inserts, mouldings and foot options allow you to finesse your space.









# functional design

Well organized kitchens are created around the idea of Functional Design. Our cabinets store everything right where you need it. Your kitchen should include a **PLACE FOR EVERYTHING** when preparing meals, cooking food, clean up and storage. Your customized dream kitchen awaits.





1 \* EVERYDAY FLATWARE



2 \* CLEANING PRODUCTS



3 \* RECYCLING & TRASH





4 \* FOOD STORAGE CONTAINERS

5 \* EVERYDAY DISHES & GLASSES





1 \* TRAY



2 \* PLATTER



3 \* SPICES



4 \* POTS AND PANS





5 \* POTS AND PANS



6 \* OIL AND VINEGAR



7 \* POTS AND PANS



8 \* MIXING BOWL





1 \* EQUIPMENT



2 \* FOOD



3 \* EQUIPMENT





4 \* TRAY

5 \* BEVERAGE



# glaze finishes

CREATING A UNIQUE LOOK

glaze over paint



The profiles of doors, drawer fronts and large mouldings are highlight glazed by hand. The highlight glazing affects only the areas where the glaze is applied, the rest of the product does not change color.

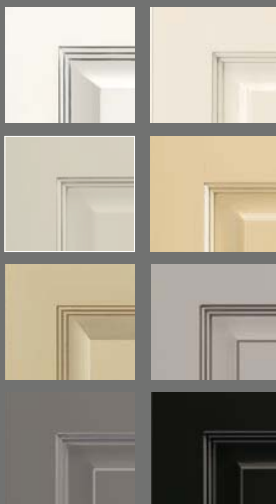

glaze over stain



Glaze is applied over the top of the base stain and then hand wiped for a unique finish. Since glazed cabinetry is hand finished, no two doors are exactly the same.

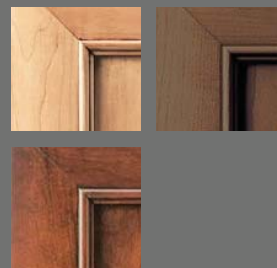



# species

## DOOR STYLES



### Maple

offers a smooth, closed grain pattern, generally off-white in color with varying tones of light pink and yellow-brown. Maple contains a natural resin that causes the wood to turn amber as it ages. Painted Maple cabinetry door styles may consist of various hardwood components.

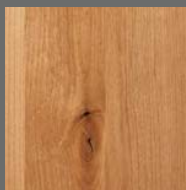

### Rustic alder

has a fine, straight-grain pattern and even texture. The color is a light brown with a reddish tinge that stains evenly. Rustic Alder includes character spots, knots, burls and blemishes which do not affect the product durability.

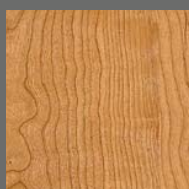

### Cherry

is a rich and multi-colored hardwood distinguished by its flowing grain pattern. Pitch pockets, checks, pin knots and sap wood all occur naturally in cherry wood. Color varies from light to deep reddish brown and will darken or mellow with age. This will be more noticeable with natural or light stain finishes.

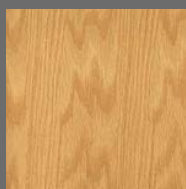

### Oak

is characterized by its wide open grain patterns and extreme durability. Variations in grain pattern and color, small knots and pin holes are attributes of nature giving oak its distinctive beauty.

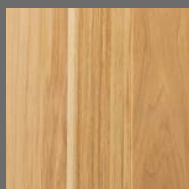

### Hickory

is known for its strength, open grain and distinctive color variation within each piece of wood. Ranging from light to deep brown, Hickory's unpredictable color spread is especially noticeable in a natural or light finish, with darker stains mellowing the variation.



### Rustic hickory

the term Rustic refers to using material that presents a more authentic country, rural feel to the cabinetry. The cabinets are designed to include a large amount of character elements in the wood.



DAWSON \* MAPLE CRANBERRY



GILBERT \* RUSTIC ALDER NATURAL  
WITH CHOCOLATE GLAZE



PACIFICA \* CHERRY SLATE 59



# finish options

## maple

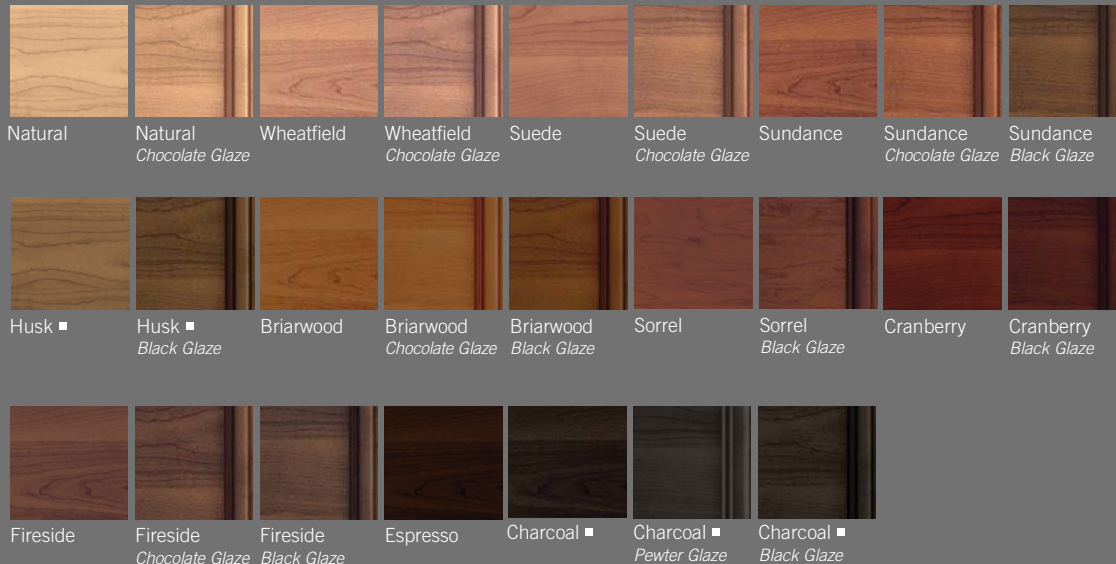

## paintable maple





## oak

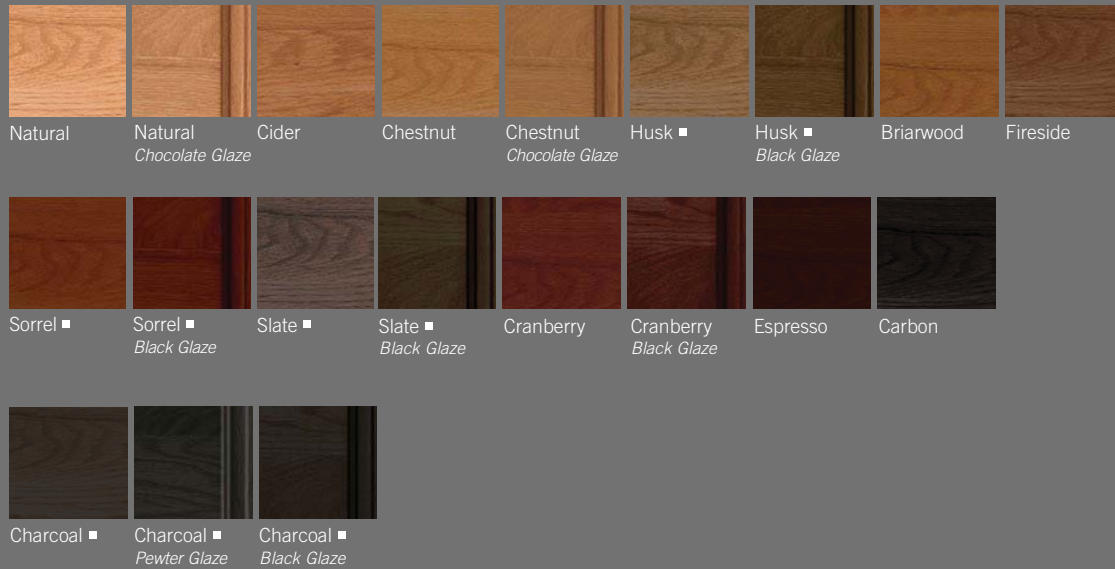

## painted oak





# finish options

## cherry



Natural Harvest Harvest *Chocolate Glaze* Harvest *Black Glaze* Husk ■ Husk ■ *Black Glaze* Briarwood Briarwood *Black Glaze* Sorrel ■ Sorrel ■ *Black Glaze*

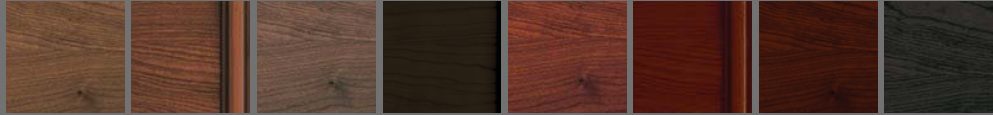

Fireside Fireside *Black Glaze* Slate ■ Slate ■ *Black Glaze* Cranberry Cranberry *Black Glaze* Espresso Carbon

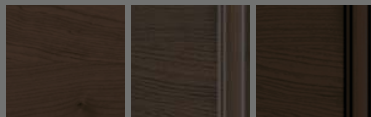

Charcoal ■ Charcoal ■ *Pewter Glaze* Charcoal ■ *Black Glaze*

## hickory/rustic hickory



Natural Natural *Chocolate Glaze* Natural *Black Glaze* Umber Umber *Chocolate Glaze* Chestnut Chestnut *Chocolate Glaze* Chestnut *Black Glaze*



Husk ■ Husk ■ *Black Glaze* Briarwood Briarwood *Chocolate Glaze* Briarwood *Black Glaze* Sorrel ■ Sorrel ■ *Black Glaze* Fireside Fireside *Black Glaze*

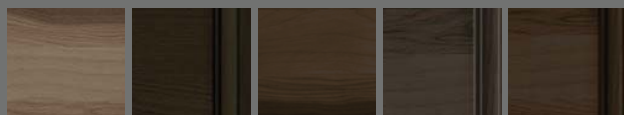

Slate ■ Slate ■ *Black Glaze* Charcoal ■ Charcoal ■ *Pewter Glaze* Charcoal ■ *Black Glaze*



## rustic alder



Natural

Natural  
Chocolate Glaze

Harvest

Harvest  
Chocolate Glaze

Harvest  
Black Glaze

Husk ■

Husk ■  
Black Glaze

Briarwood

Briarwood  
Black Glaze

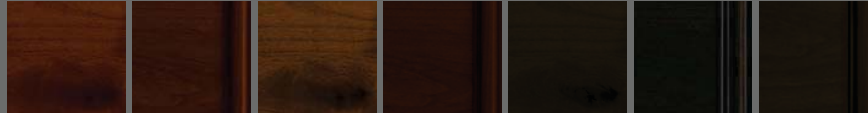

Sorrel ■

Sorrel ■  
Black Glaze

Fireside

Fireside  
Black Glaze

Charcoal ■

Charcoal ■  
Pewter Glaze

Charcoal ■  
Black Glaze

■ Inspired Finish

## foil

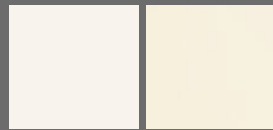

White

Antique White



### NATIONAL BREAST CANCER FOUNDATION

Mid Continent Cabinetry is a proud sponsor of the National Breast Cancer Foundation.

*Help for Today... Hope for Tomorrow®*



### AT HOME IN AMERICA FOR ALMOST HALF A CENTURY

Mid Continent Cabinetry...crafted by your American neighbors.



### A SMALL CONTRIBUTION CAN LEAVE A BIG MARK

Each year, we work with the Arbor Day Foundation to replace trees displaced by our manufacturing, with the goal of replanting 10,000 trees each year. Social responsibility is growing, and we want to be on that forefront.



COVER: ROHE \* PAINTED MAPLE EBONY  
ISLAND: GARRISON \* PAINTED MAPLE STONE



**Mid Continent Cabinetry**

950 Blue Gentian Road, Suite 200, Eagan, MN 55121  
866-802-7892 • [www.midcontinentcabinetry.com](http://www.midcontinentcabinetry.com)

*Our goal is to offer our customers the utmost in quality and performance. Therefore, Mid Continent Cabinetry reserves the right to change design, specifications, or materials as necessary.*

*Due to printing inconsistencies, the finishes shown may not be accurately represented. To experience the true beauty of our finishes, see your showroom display.*



Specifications subject to change without notice

©2017 Norcraft Companies



L000099/617/10000